

# southern boundary typical detail

## Kendel Village Environmental Living

11

Dec 2010

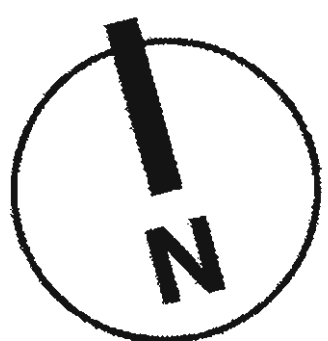

**FRONT GARDENS**  
SMALL AND MEDIUM HEIGHT MASS PLANTING TO FRONT GARDENS, WITH OCCASIONAL ACCENT PLANTS. SPECIES SELECTION FROM TYPICAL "SUN" PLANT SCHEDULES.

**COMMON BOUNDARY**  
1500MM HIGH COLORBOND FENCE (SHOWN MAGENTA) TO COMMON SIDE BOUNDARIES, WHERE ADJOINING PRIVATE OPEN SPACE. RURAL FENCE TO REMAINDER OF COMMON BOUNDARY AS SHOWN IN SECTION. OPPORTUNITY FOR SCREENING SHRUBS ADJACENT TO FENCELINE, OTHERWISE USE LOW SHRUBS FROM TYPICAL "SUN" PLANT SCHEDULE TO PERMIT OPEN VIEWS THROUGH RURAL FENCE.

**DRYING AREAS**  
SLATTED SCREEN TO DRYING AREA WHERE VISIBLE FROM EXTERNAL LIVING AREAS. 1800MM HIGH COLORBOND FENCE (SHOWN RED) ADJOINING DRYING AREA AT SIDE BOUNDARY TO SUPPORT DRYING LINE AND SCREEN VIEWS IN.

**SWALE**  
OCCASIONAL SMALL NATIVE TREES TO NORTHERN SIDE OF DRAINAGE SWALE, UNDERPLANTED WITH NATIVE SHRUBS AND MACROPHYTES.

**SOUTHERN BOUNDARY**  
1800MM HIGH COLORBOND FENCE TO SOUTHERN BOUNDARY AS PER COUNCIL REQUEST.

- NEW EVERGREEN TREES.
- NEW DECIDUOUS TREES.
- FEATURE AND SCREENING SHRUBS.
- MIXED MASS PLANTING.
- NEW TURF.
- CROSSING THRESHOLD AS NOTED.
- PUBLIC PATHWAY:  
OXIDE COLOURED CONCRETE WITH ROCK SALT FINISH.
- PUBLIC PATHWAY NODAL POINTS:  
EXPOSED AGGREGATE COLOURED CONCRETE.
- DECOMPOSED GRANITE PATH.
- PUBLIC BENCH SEATING
- 1800MM HIGH COLORBOND FENCE.
- 1800MM HIGH SLATTED SCREEN.
- 1500MM HIGH COLORBOND FENCE.
- TIMBER POST & RAIL FENCE.



**SHADE PLANTING**  
PLANTING TO CONSIST OF SHADE TOLERANT SPECIES WHERE MASS PLANTING IMMEDIATELY ADJOINS BUILDING. REFER TYPICAL "SHADE" PLANT SCHEDULE.

**FENCES**  
1800MM HIGH COLORBOND FENCE TO SCREEN DRYING AREA AND TO AFFIX DRYING LINE TO. RURAL STYLE FENCE TO REMAINDER OF COMMON BOUNDARY TO EDGE OF SWALE.

**REAR GARDENS**  
SMALL DECIDUOUS TREE AS ACCENT POINT. WHEN VIEWED FROM SITTING AREA. MIXED MASS PLANTING OF SCREENING AND SMALLER SHRUBS FROM TYPICAL "SUN" PLANT SCHEDULES PROVIDE STRUCTURE TO SOFT LANDSCAPING, WITH INFILL PLANTING OF ORNAMENTAL GRASSES AND GROUNDCOVERS.

**DRAINAGE SWALE**  
DRAINAGE SWALE APPROX 5M WIDE ALONG SOUTHERN BOUNDARY. CANOPY TREES AND SCREENING SHRUBS TO UPPER EMBANKMENT WITH MACROPHYTE PLANTING AS SCHEDULED WITHIN SWALE BASIN. SPECIES TO INCLUDE LOMANDRA, ISOLEPIS AND CAREX. CANOPY TREES TO INCLUDE EUCALYPTUS ROBUSTA, TRISTANIOPSIS AND CASUARINA. REFER SECTION FOR ADDITIONAL DETAIL.

**REAR YARD PLANTING**  
SMALL DECIDUOUS FEATURE TREE AS ACCENT POINT WHEN VIEWED FROM PRIVATE OPEN SPACE. UNDERPLANTED WITH MIXED SHRUBS AND ORNAMENTAL GRASSES FROM TYPICAL

**COMMON BOUNDARY FENCE**  
1800MM HIGH COLORBOND FENCE WHERE COMMON SIDE BOUNDARY ADJOINS DRYING AREA, TO SCREEN AND FACILITATE FIXING OF DRYING LINE. TIMBER POST AND RAIL FENCE TO REMAINDER OF COMMON BOUNDARY TO REFLECT THE RURAL THEME OF THE LOCALITY.

**DRAINAGE SWALE**  
SMALL RETAINING WALL ALONG NORTHERN SIDE OF DRAINAGE SWALE WITH LARGE SCREENING SHRUBS TO EDGE AND MACROPHYTE PLANTING WITHIN BASIN OF SWALE.

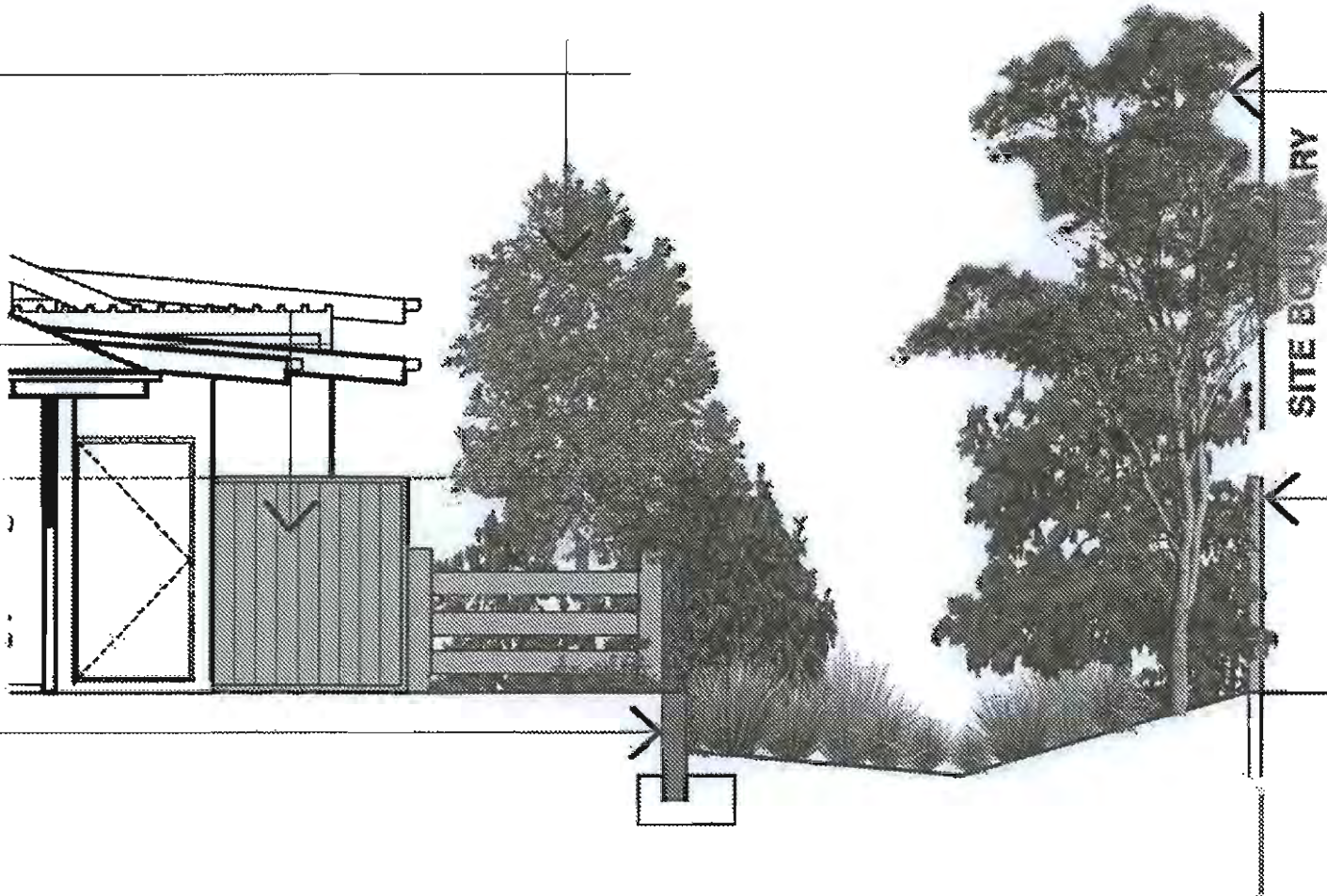

**DRAINAGE SWALE**  
SMALL AND MEDIUM NATIVE CANOPY TREES TO UPPER EMBANKMENT OF SOUTHERN SIDE OF SWALE, UNDERPLANTED WITH NATIVE SHRUBS. MACROPHYTE PLANTING TO LOWER PORTIONS TO INCLUDE LOMANDRA, CAREX AND ISOLEPIS.

**FENCE**  
1800MM HIGH COLORBOND FENCE TO SOUTHERN BOUNDARY AS NOTED ON LANDSCAPE MASTERPLAN.

SECTION A

**site details:**  
Burton Road,  
Mount Hutton  
**client:**  
Helen & Ken Delforce  
**date:**  
20.12.10  
**job number:**  
8572.5  
**scale:**  
APPROX 1:100 @ B1  
**rev. number:**  
F



# communal area typical detail

## Kendel Village Environmental Living

12

Dec 2010

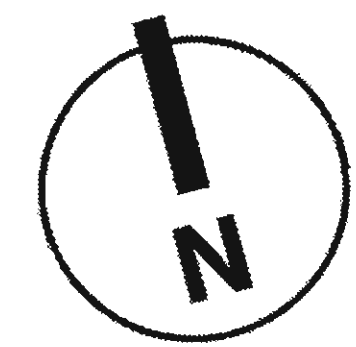

### SITTING AREA

CURVED SITTING AREA ADJOINING NORTHERN LANDSCAPED SETBACK. COMPACTED DECOMPOSED GRANITE ACCESS PATH AS A "SOFT" PAVEMENT ALTERNATIVE IN "BUSHLAND" CONTEXT AND TO PERMIT GREATER SURFACE WATER PERMEABILITY.

MEDIUM TO LARGE NATIVE SHRUB BUFFER PLANTING TO REAR WHILST FOREGROUND PLANTING TO CONSIST OF SMALL NATIVE SHRUBS AND GRASSES TO ENABLE CASUAL SURVEILLANCE OF SITTING AREA AND CLEAR SIGHTLINES ALONG INTERNAL ROAD.

NATIVE CANOPY TREES WITHIN LANDSCAPED BUFFER PROVIDE SCREENING FROM NORTHERN ELEVATED LOCATIONS AND A VISUAL LINK WITH EXISTING VEGETATION TO BE RETAINED.











NATIVE FEATURE PLANTING ADJOINING SITTING AREA TO INCLUDE:

WESTRINGIA 'ZENA'  
DWARF LILLY PILLY  
DWARF BANKSIA  
LOMANDRA CVS  
DIANELLA CVS

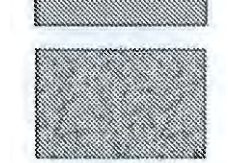
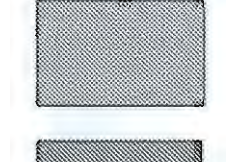
SCREENING SHRUBS TO DWELLING SIDE BOUNDARIES AS GREEN BACKDROP TO PUBLIC OPEN SPACE.

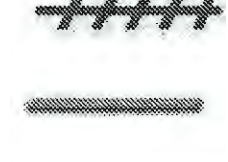
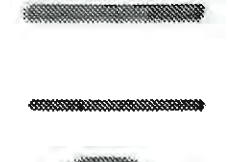
SMALLER DECIDUOUS TREES (LAGERSTROEMIA) TO INTERNAL CIRCLE FOR ADDITIONAL INTEREST AND SEASONAL VARIATION.

### LEGEND

-  NEW EVERGREEN TREES.
-  NEW DECIDUOUS TREES.
-  FEATURE AND SCREENING SHRUBS.
-  MIXED MASS PLANTING.
-  NEW TURF.
-  CROSSING THRESHOLD: COLOURED CONCRETE, CCS "IGUANA".
-  PUBLIC PATHWAY: OXIDE COLOURED CONCRETE WITH ROCK SALT FINISH.
-  PUBLIC PATHWAY NODAL POINTS: EXPOSED AGGREGATE COLOURED CONCRETE.
-  DECOMPOSED GRANITE PATH.
-  PUBLIC BENCH SEATING
-  1800MM HIGH COLORBOND FENCE.
-  1800MM HIGH SLATTED SCREEN.
-  1500MM HIGH COLORBOND FENCE.
-  TIMBER POST & RAIL FENCE.
-  LIGHT TYPE 1: EQUAL TO WARP 9 POLE MOUNTED.
-  LIGHT TYPE 2: BOLLARD.

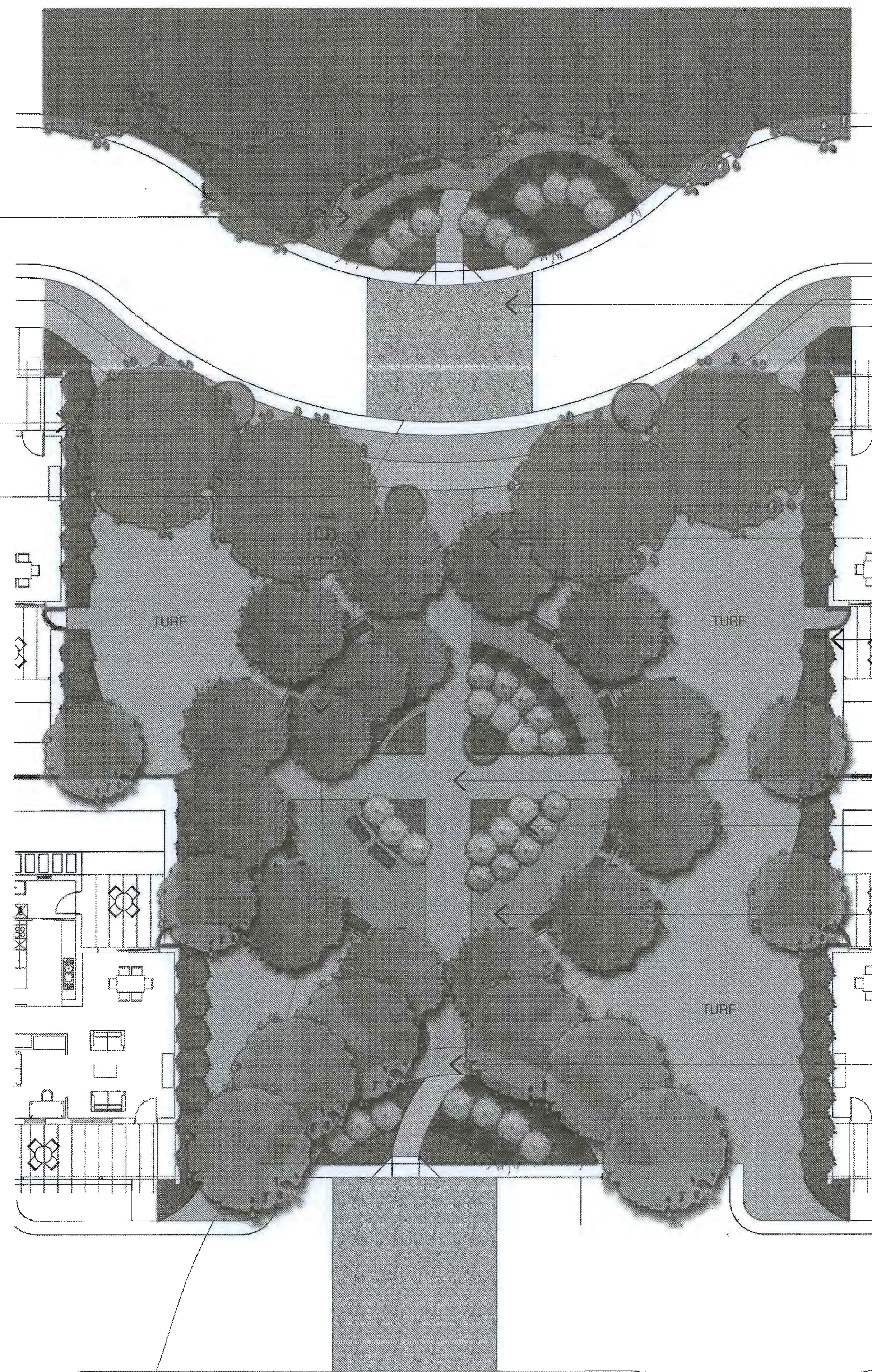

### CROSSING THRESHOLD

PEDESTRIAN CROSSING THRESHOLD WITH SPEED CONTROL HUMPS IN OXIDE COLOURED CONCRETE IN CONTRASTING COLOUR TO REMAINDER OF ROADWAYS. COLOUR EQUAL TO CCS "IGUANA".

### STREET TREES

SMALL EVERGREEN TREES (WATERHOUSIA FLORIBUNDA) WHERE SPACE PERMITS ALONG ROADSIDE VERGE.

FEATURE PLANTING OF SAPIUMS TO CIRCUMFERENCE OF COMMUNAL AREA FOR VISUAL INTEREST AND TO ASSIST IN DEFINING THE AREA AS UNIQUE.

### BOUNDARY FENCES

SIDE BOUNDARY FENCES ADJOINING COMMUNAL OPEN SPACE TO BE TIMBER POST AND RAIL (SHOWN BLUE) TO PROVIDE OUTLOOK ONTO PUBLIC LANDSCAPED AREA AND REINFORCE RURAL THEME INCORPORATED THROUGHOUT THE SITE. COMMON BOUNDARY FENCES TO BE 1500MM HIGH COLORBOND (SHOWN MAGENTA) AT COUNCIL REQUEST AND AS BUSHFIRE HAZARD PREVENTION.

EXPOSED AGGREGATE CONCRETE PATH ALONG MAIN PEDESTRIAN AXIS FOR GREATER DURABILITY REQUIRED FOR HIGH USE AREAS.

SMALL SHRUBS AND GRASSES ACCENTUATE CIRCULAR FORMATION OF PUBLIC SPACE, WHILST MAINTAINING SIGHTLINES FOR PERSONAL SAFETY OF RESIDENTS.

### COMMUNAL OPEN SPACE

CIRCULAR INFORMAL MEETING PLACE WITH SEATING AND DECIDUOUS FEATURE TREES. CENTRALLY LOCATED FOR CONVENIENT ACCESS.

SMALL NATIVE CANOPY TREES PROVIDE VISUAL LINK ACROSS SITE.

### PUBLIC SITTING AREA

ARC SHAPED SITTING AREA ADJOINING CROSSING THRESHOLD AS INFORMAL MEETING AND RESTING PLACE FOR RESIDENTS.

SMALL CANOPY TREES (TRISTANIOPSIS / WATERHOUSIA) TO REAR TO FRAME AREA WITH SMALL NATIVE SHRUBS, GRASSES AND GROUNDCOVERS IN ROADSIDE VERGE TO DEFINE THE DIFFERENT USAGE OF THE AREA.

### site details:

Burton Road,  
Mount Hutton

### client:

Helen & Ken Delforce

### date:

20.12.10

### job number:

8572.5

### scale:

APPROX 1:100 @ B1

### rev. number:

F



# northern setback typical detail

## Kendel Village Environmental Living

13

Dec 2010

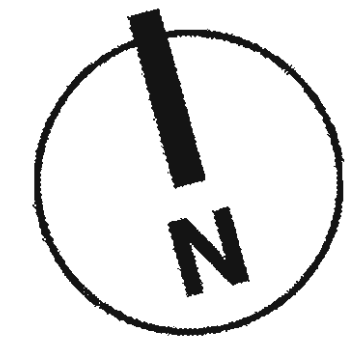

### NORTHERN BOUNDARY

EXISTING POST AND WIRE FENCELINE TO BE RETAINED ALONG NORTHERN BOUNDARY, SO AS PERMIT VIEWS FROM ADJACENT RESIDENCES INTO THE REVEGETATED BUFFER ZONE.

### CANOPY TREES

LARGE CANOPY TREES TO CONSIST OF:  
EUCALYPTUS MICROCORYS  
EUCALYPTUS PUNCTATA

MEDIUM CANOPY TREES TO INCLUDE:  
ANGOPHORA COSTATA  
EUCALYPTUS UMBRA  
EUCALYPTUS GUMMIFERA  
CORYMBIA MACULATA

SMALL CANOPY TREES TO INCLUDE:  
CASUARINA GLAUCA (NEARER TO CREEKLINE)  
MELALEUCA QUINQUENERVIA (NEARER TO CREEKLINE)  
EUCALYPTUS ROBUSTA

GENERALLY TREES TO BE PLANTED AT APPROXIMATELY 4M CENTRES, TO ENCOURAGE STRONG UPRIGHT GROWTH. TREES TO BE INTERPLANTED WITH MIXED MASS NATIVE SHRUBS AS SHOWN IN TYPICAL UNDERSTOREY PLANTING LAYOUT.

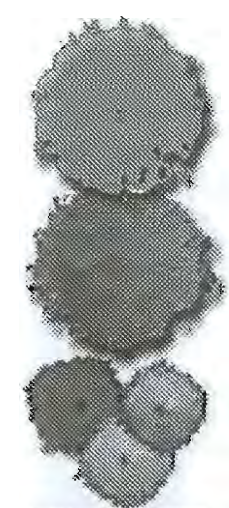

NEW EVERGREEN TREES.

NEW DECIDUOUS TREES.

FEATURE AND SCREENING SHRUBS.



MIXED MASS PLANTING.

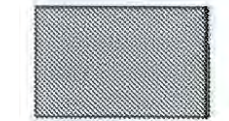

NEW TURF.



PUBLIC PATHWAY:  
OXIDE COLOURED CONCRETE WITH ROCK SALT FINISH.



PUBLIC PATHWAY NODAL POINTS:  
EXPOSED AGGREGATE COLOURED CONCRETE.



DECOMPOSED GRANITE PATH.



PUBLIC BENCH SEATING



1800MM HIGH COLORBOND FENCE.



1800MM HIGH SLATTED SCREEN.



1500MM HIGH COLORBOND FENCE.



TIMBER POST & RAIL FENCE.



LIGHT TYPE 1:  
EQUAL TO WARP 9 POLE MOUNTED.



LIGHT TYPE 2:  
BOLLARD.

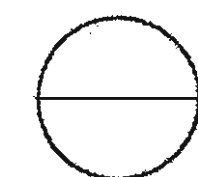
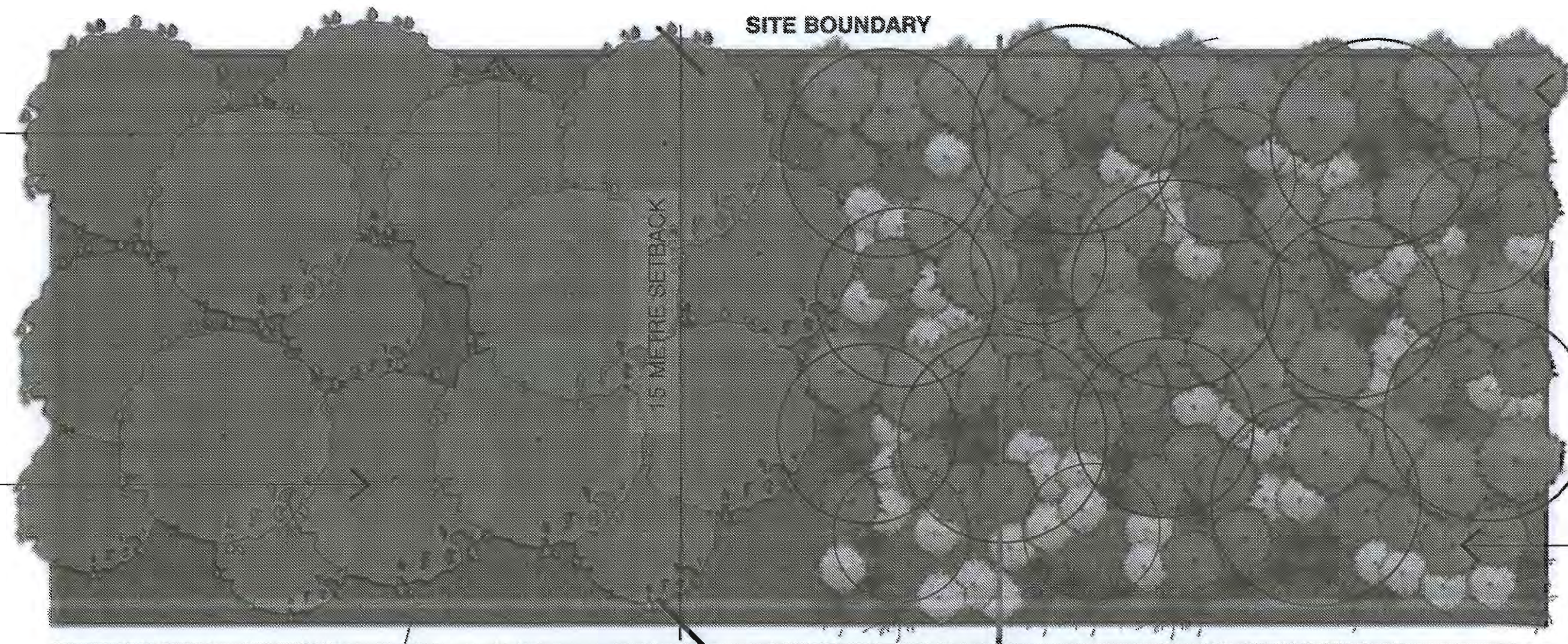

TYPICAL CANOPY PLAN

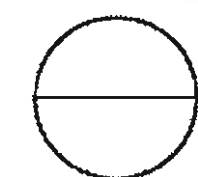
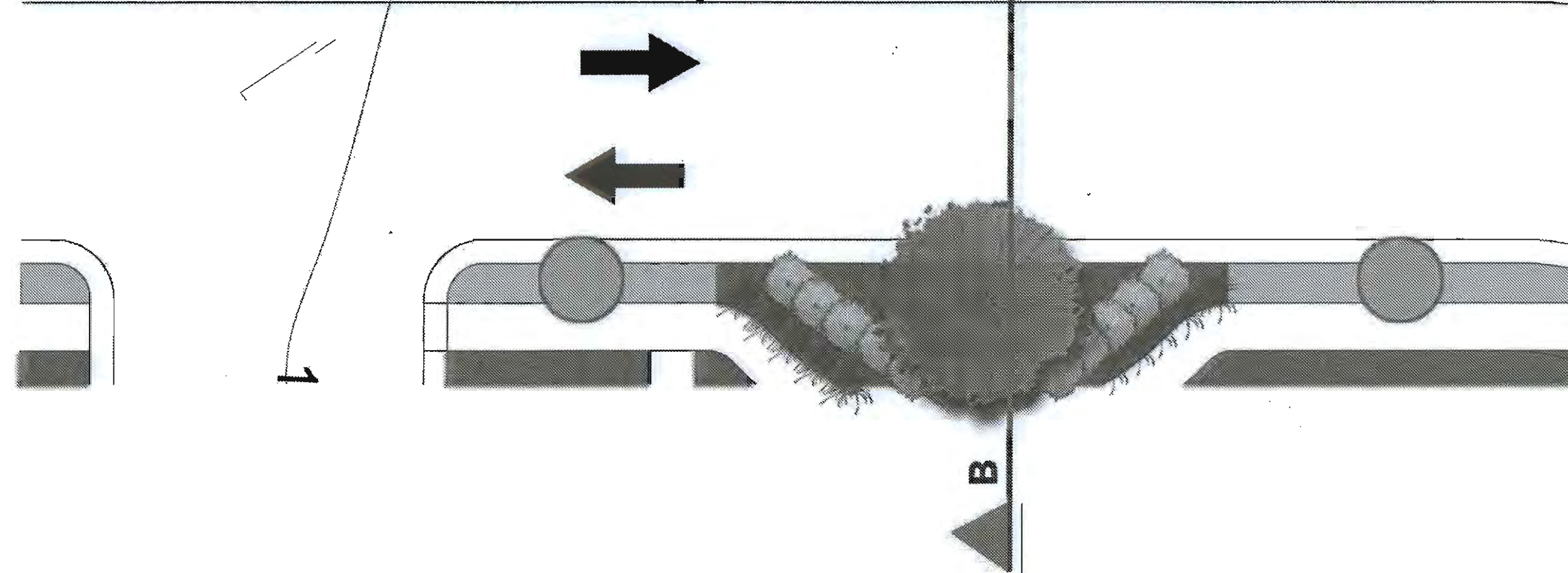

TYPICAL UNDERSTOREY PLAN

### SOUTHERN CARRIAGEWAY

OPPORTUNITY FOR SMALL TREE PLANTING AT NODAL POINT ADJOINING INTERNAL ACCESS ROAD. LOW MASS PLANTING TO ENSURE SIGHTLINES ARE MAINTAINED.

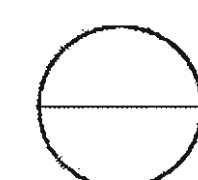
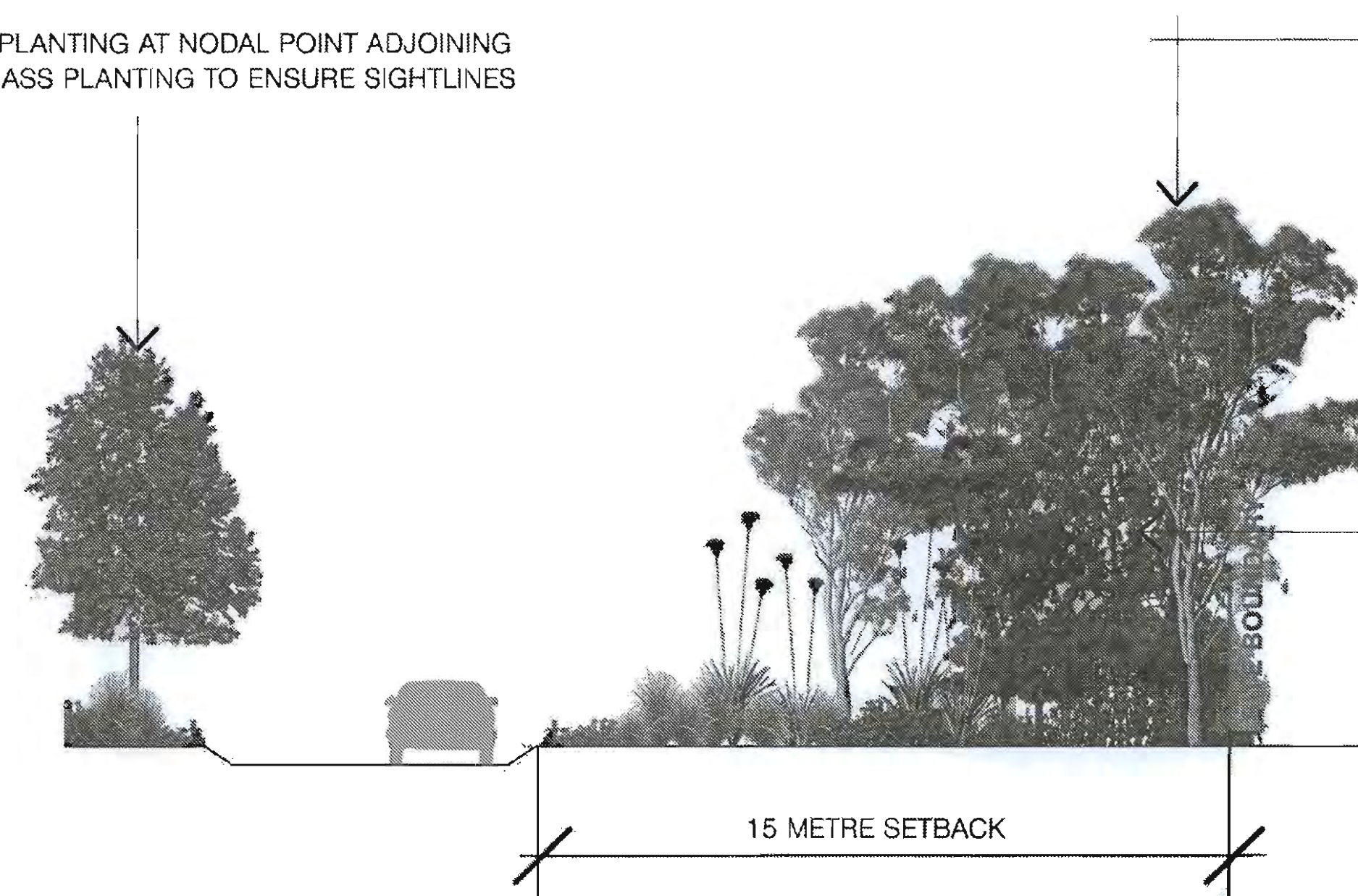

SECTION B

### LARGE SHRUBS

LARGE NATIVE SHRUBS PLANTED PREDOMINANTLY TOWARDS THE REAR OF THE BUFFER ZONE TO CREATE A GREEN SCREEN WHEN VIEWED FROM NORTHERN ADJOINING PROPERTIES. CANOPY TREES OVER SHOWN OUTLINED FOR CLARITY.

SPECIES TO INCLUDE:  
ACACIA  
BANKSIA  
CALLISTEMON  
MELALEUCA  
AT APPROXIMATELY 2-3M CENTRES. INFILL PLANTING OF MEDIUM AND SMALL SHRUBS.

### INFILL PLANTING

GENERALLY SMALLER SHRUBS AND NATIVE GRASSES AS INFILL TO STRUCTURAL PLANTINGS AND IN HIGHER PROPORTIONS NEARER TO THE INTERNAL ROAD. PLANTING RATE APPROXIMATELY 1 PLANT PER METRE, DEPENDING UPON SPECIES, AS REQUIRED TO ACHIEVE A RAPID COVERAGE WITHIN THIS ZONE. THIS WILL CREATE A TIERED EFFECT WHEN VIEWED FROM WITHIN THE SITE WHILST MAINTAINING SIGHTLINES ALONG THE ROADSIDE VERGE (REFER SECTION).

SPECIES TO INCLUDE:  
WESTRINGIA  
SYZYGIUM  
BANKSIA  
DORYANTHES  
LOMANDRA  
DIANELLA  
KENNEDIA

### CANOPY TREES

LARGE CANOPY TREES MAINLY TO REAR OF BUFFER PLANTING ZONE, WITH MEDIUM AND SMALLER TREES TOWARDS FRONT.

### UNDERSTOREY

UNDERSTOREY PLANTING TO CONSIST OF LARGE NATIVE SHRUBS TO FORM A GREEN SCREEN WHEN VIEWED FROM NORTHERN PROPERTIES. SHRUBS HEIGHT TO GENERALLY TIER DOWN TOWARDS THE FRONT OF THE BUFFER ZONE, TERMINATING WITH NATIVE GRASSES AND GROUNDCOVERS ADJACENT TO ACCESS ROAD.

### FENCE

EXISTING FENCE TO BE RETAINED ALONG NORTHERN BOUNDARY.

### site details:

Burton Road,  
Mount Hutton

### client:

Helen & Ken Delforce

### date:

20.12.10

### job number:

8572.5

### scale:

APPROX 1:100 @ B1

### rev. number:

F